

# LEGAL METROLOGY

## CERTIFICATION APPLICABLE TO REGULATED MEASURING INSTRUMENTS

If you wish to market your regulated measuring instruments in France, in Europe, and worldwide, the LNE allows you to certify their design in application of regulatory requirements. As a manufacturer, repairer or installer of regulated measuring instruments, the certification of your quality management system also allows you to gain flexibility.

### THE ROLE OF LEGAL METROLOGY

Legal metrology covers a set of requirements and control procedures imposed by the State to guarantee the accuracy of certain measuring instruments, in order to ensure, among other things, the protection of the citizen, the fairness of trade and the proper application of laws and regulations.

The amended decree of May 3, 2001 relating to the control of measuring instruments defines the provisions applicable in France for the **37 categories of regulated instruments** (weighing instruments, water meters, electricity meters, taximeters, breathalyzers, cinemometers, etc.).

With the globalization of trade, reference texts are now also drawn up at **European level**. Thus, certain measuring instruments are the subject of two European directives, Directive 2014/32/EU relating to measuring instruments (MID Directive), and Directive 2014/31/EU relating to non-automatic weighing instruments. These two texts make it possible to harmonize the technical requirements applicable to these instruments and the checks carried out before they are put into service. These two directives, as well as certain national regulatory texts, are based in particular on recommendations from the International Organization of Legal Metrology (OIML).



### THE LIFE CYCLE OF A REGULATED MEASURING INSTRUMENT AND THE ROLE OF LNE

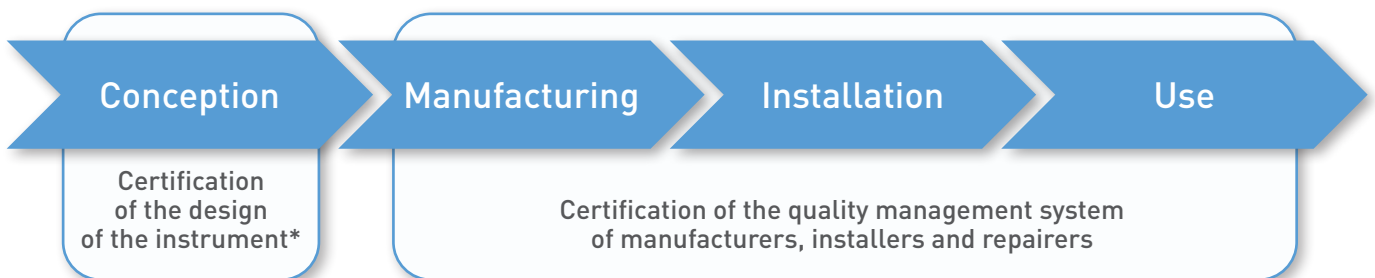

\* Type/design examination according to regulations



or



## Main steps of the type-examination

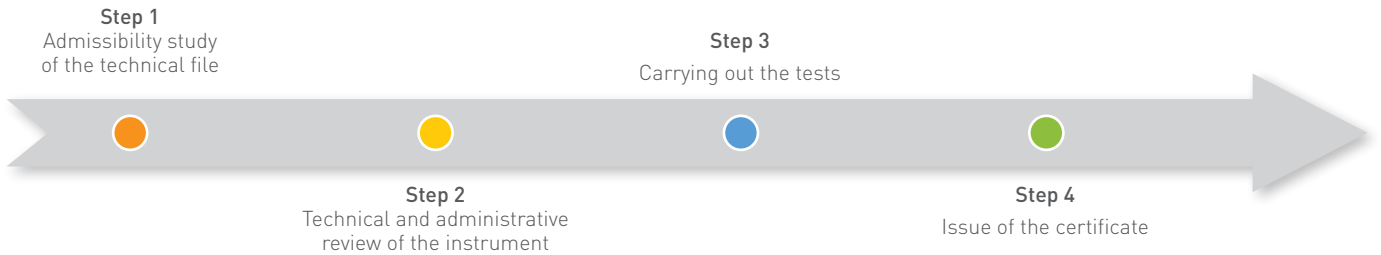

## Main audit steps for manufacturers/repairers/installers

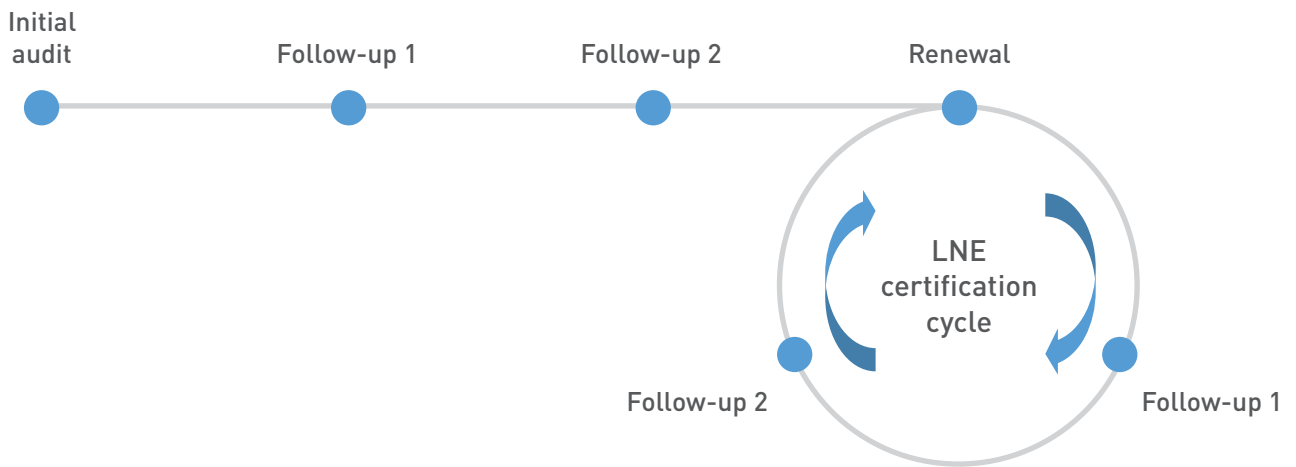

## WHY CHOOSE LNE

As the leader of French metrology and a national reference laboratory in the field of metrology, LNE offers a wide range of certifications for products, services and quality management systems valid on national, European and international markets, and can act as a:

- **French body designated by the Ministry of Industry under Decree No. 2001-387 for:**
  - examining applications and issuing certificates for type examination, design approval and installation verification,
  - approving and monitoring the quality management systems of manufacturers, repairers or installers of measuring instruments.

- **Notified body in Europe for conformity assessment:**

- **Measuring instruments under Directive 2014/32/EU (MID)** for most conformity assessment modules (EU type examination, EU unit verification, quality assurance of the manufacturing process or full quality assurance for manufacturers),
- **NAWI (Non Automatic Weighing Instruments)**, under Directive 2014/31/EU, for EU type examination, EU unit verification, and approval of manufacturers' quality management systems.

- **Issuing authority for OIML CS certificates of conformity at international level.**

Through its subsidiary **LNE-GMED** UK LNE GROUP

LNE also issues the UKCA\* mark on your regulated measuring instruments.

\* Subsidiary in process of accreditation.

**UK CA**

LABORATOIRE NATIONAL DE MÉTROLOGIE ET D'ESSAIS  
1, rue Gaston Boissier • 75724 Paris Cedex 15 • France

A specialized and dedicated sales team is at your service.

